



R3T Installation Instructions

Inserting R3T Plug-in module onto 4" R3D® Remote Ready Dial

- 1) Unscrew and remove existing cover screws from Magnetel® 4" R3D® dial. Same cover screws need to be removed if Magnetel® Light Module is currently installed on the dial.



- 2) Carefully remove existing cover plate and remove plug.

Note: If Magnetel® Light Module is currently installed, carefully remove light cover, remove strain relief clip, and move light module cover aside.

Cover Plate

Plug



- 3) Insert and snap the plug in module from the R3T into recess on the 4" R3D® dial crystal.

Strain Relief Clip



Light Module

Plug in Module
from R3T

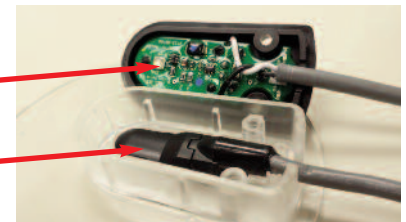

- 4) Snap Light Module cover back onto crystal ensuring wiring from the light module is over the R3T plug-in module wire. Once this is complete, the strain relief clip is no longer needed and can be discarded.

*Light Module and Remote Monitoring
Plug-in module utilized simultaneously.*



* Materials and specifications are subject to change without notice.

Mounting R3T Transmitter

For optimum mounting, the R3T Transmitter should be installed on a clean surface near Magnetel® Dial. Installing the transmitter inside any containers could compromise signal strength severely.

1. Locate a smooth, clean, and dry surface within 1 ft. of Magnetel® Dial.
2. Remove liner on adhesive tape currently installed on back side of R3T Transmitter.
3. Gently press R3T Transmitter onto surface and hold for 60 sec.
4. Re-route any excess wire between R3T Transmitter and Magnetel® R3D® Dial.

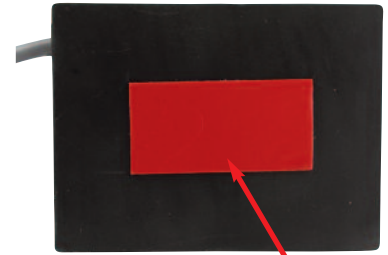

Adhesive Tape Liner

Activating R3T Transmitter and Tracking Through R3T App

Rochester R3T App is currently available for Apple and Android Phones and Tablets. Download the Rochester R3T App below:



1. Once the plug in module is installed into the 4" R3D® dial and R3T Transmitter is mounted onto surface, remove magnet that is currently positioned in the slot of the R3T. This will activate the R3T.
2. Open the R3T App and choose "Connect to Gauges". The R3T serial number should appear under "Found Gauges". The serial number of the R3T Transmitter can be found on the device label.

Note: The R3T Transmitter signal is emitted via Bluetooth. To ensure successful connection to the device, it must be within 10 meters unobstructed.

3. Save the Found gauge and exit Connect to Gauges. Once this is complete, tank level of the R3T enabled gauge will be displayed immediately on the app.
4. The serial number is defaulted as the name of the tank. One can tap on the serial number and customize the name of the tank.



Magnet

R3T App allows connection to multiple tanks allowing user to track multiple tank levels. User can swipe through each saved R3T enabled gauge once connected.